

DIMMINUTOR®

Powerful Channel Grinder

The DIMMINUTOR® provides automatic screening and grinding of liquid borne solids with a straight through open channel design. This unit effectively reduces plastics, wood, vegetable matter, disposables, and other oversized items to fine particules. The unique features of the DIMMINUTOR are heavy precision construction, dependable operation and simplified maintenance, earning it a solid reputation amongst operators and specifying engineers worldwide.



Keeps Systems Running Smoothly | High Flow, Low Headloss | Rugged Seamless Screen
Efficient Design | Individually Replaceable Cutters | No Bottom Seals or Bearings

Continuous Torque Rotation

The DIMMINUTOR employs a smooth, continuously rotating high torque design. As its three bidirectional rotary cutters intermesh at close clearance with stationary cutters, solids are finely reduced to a size small enough to pass through a sizing screen. The DIMMINUTOR is designed for unobstructed flow even during reversing cycles. The DIMMINUTOR design has no gaps or openings between the screen and cutters, so output is controlled and complete reduction assured.

Features

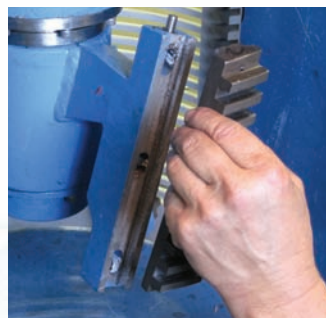

The DIMMINUTOR is designed for reliable operation and easy maintenance. With its cantilevered design, the DIMMINUTOR needs no seals or bearings near the gritty channel floor. The unit's screen is stationary so it never wears against bottom grit. Each cutter is interchangeable and cutters can be removed or adjusted independently. The unit's seals and bearings are immersed in an oil bath for long life and low maintenance. Cutters can be removed in the channel without requiring the unit to be disassembled. Maintenance of the DIMMINUTOR is quicker and easier than any other unit on the market today.

Franklin Miller®
SEE THE DIFFERENCE

Construction

Each DIMMINUTOR component is constructed for long life and precision. The cutters are constructed of hardened stainless steel for superior corrosion resistance. With the DIMMINUTOR's unique Clear-slot™ system, the cutters actually penetrate the individual slots of the screen and clear them with each revolution. The screens are precision cut from heavy stainless steel plate and designed for high strength.

S250 Control System:

An S250 Control System monitors unit operation and automatically cycles the grinder in case of an overload condition. This industrial control panel is supplied complete with a NEMA 4X FRP enclosure, and 100,000 hour life LED indicators.



Above Left: A pair of T15's installed at plant headworks.



Options

- Submersible Motors | Hydraulic Drives | Overflow Bar Screen
- Shaft Extensions Channel Frames | Wet Well Frames | Guide Rails
- Stainless Construction | S250 Control System

Configurations

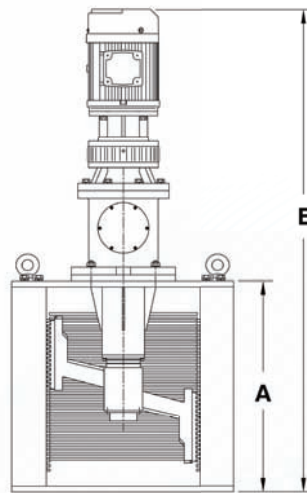
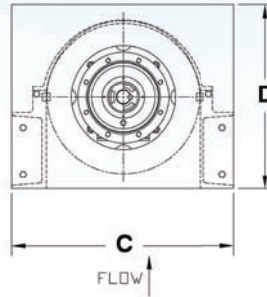

The DIMMINUTOR is designed for ease of use and versatility. These units can be installed in straight through channels, wet wells or water inlets. They can be installed for full or occasional submergence. Units can be supplied with a standard bolt down sole plate or channel frames. Guide rails can also be supplied to facilitate removal from wet wells. A variety of drive configurations is available to meet most installation requirements including standard electric motors, dry running, (IP68) submersible explosion-proof motors, extended shafts or hydraulic systems.

MODEL NO.	A	B	C	D	FLOW RANGE AVG. MGD (m³/hr)	CAPACITY Max MGD (m³/hr)	WEIGHT	HP (kW)
DM-T15	22.62" (575 mm)	58" (1473 mm)	19" (483 mm)	15.3" (387 mm)	0.4 - 3.7 (70 - 680)	5.0 (790)	750 lbs (340 kg)	3 (2.2)
DM-T20	27.5" (699 mm)	64" (1626 mm)	29" (737 mm)	24" (610 mm)	0.8 - 6.4 (130 - 1010)	8 (1260)	1000 lbs (450 kg)	3 (2.2)
DM-T25	35" (889 mm)	72" (1829 mm)	35" (889 mm)	29" (737 mm)	1.3 - 9.7 (210 - 1500)	13 (2050)	1600 lbs (730 kg)	3 (2.2)
DM-T36	44.62" (1133 mm)	84" (2134 mm)	47" (1194 mm)	42" (1067 mm)	2.4 - 17.2 (370 - 2710)	22.9 (3610)	2800 lbs (1270 kg)	3 (2.2)
DM-T36XF	58" (1473 mm)	112" (2845 mm)	47" (1194 mm)	42" (1067 mm)	3.5 - 24.9 (550 - 3920)	32 (5050)	3400 lbs (1540 kg)	5 (3.7)
DM-T42	58" (1473 mm)	112" (2845 mm)	53" (1346 mm)	47" (1194 mm)	4.6 - 32.6 (720 - 5190)	42.5 (6200)	4400 lbs (2000 kg)	5 (3.7)

US gallon = 3.79 liters

Call one of our customer service representatives to discuss your particular application.

The following United States Patents may apply: 4,186,888; 8,727,248